

Product Data Series M1200

M1233 Flush Grid 0.5"



Main Industry Segments

Food industry: Meat, Poultry, Fish processing, Bakery, Fruit and Vegetables

Non-Food industry: -

Description

- "Nosebar transfer", recommended diameter 18 mm (0.71"); 16 mm (0.63") possible
- 25% open area; 70% open contact area; largest opening 5x6 mm (0.2"x0.25")
- Food approved materials
- Open hinge
- Superior cleanability
- Rod diameter 5 mm (0.2")
- "Open window" sprockets

Available accessories

- Flights
- GripTop modules

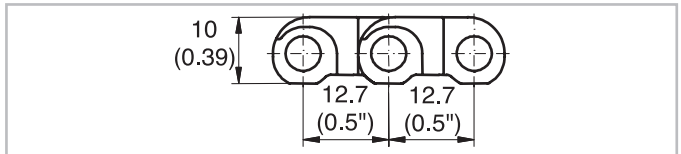
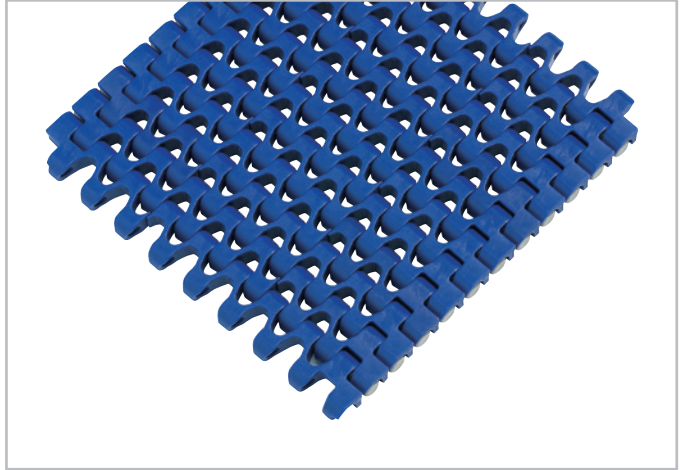

Belt data

Belt material		PP	PE	POM			PA +US	PA
Rod material		PP	PE		PP	PA		
Nominal tensile strength	N/m	11000	7000	8000	16000	18000	17000	17000
F_N straight run	lb/ft	750	480	548	1096	1233	1165	1165
Temperature range	°C	5 - 105	-70 - 65	-40 - 65	5 - 90	-40 - 90	-46 - 116	-46 - 130
	°F	40 - 220	-94 - 150	-40 - 150	40 - 195	-40 - 195	-50 - 240	-50 - 266
Temperature maximum (short-term)	°C						135	160
	°F						275	320
Belt weight m_b	kg/m ²	5.2	5.4	7.2	7.2	7.2	6.7	6.7
	lb/sqft	1.07	1.11	1.48	1.48	1.48	1.37	1.37

Diameter of idling rollers (minimum)		Diameter of support rollers (minimum)		Diameter for gravity take-up and center drive rollers (minimum)		Backbending radius for elevators without side-guards or hold down devices (minimum)		Backbending radius for elevators with side-guards or hold down devices (minimum)	
mm	inch	mm	inch	mm	inch	mm	inch	mm	inch
18	0.7	50	2	75	3	150	6	250	6

Standard range of belt widths b_0

mm (nom.)	150	200	250	300	350	400	450	500	550	600	650	700	750	800	etc.
inch (nom.)	6	8	10	12	14	16	18	20	22	24	26	28	30	32	etc.

Real belt widths are in most cases 0.1% to 0.3% smaller.

Standard belt widths in increments of 50 mm (2"). Non-standard widths are offered in increments of 16.66 mm (0.66"). Smallest possible width 83.4 mm (3.25").

For detailed material properties refer to the HabasitLINK® Engineering Guidelines or contact your Habasit representative.

Product Data Series M1200

M1233 Flush Grid 0.5"



The nominal tensile strength is valid for 23 °C (73 °F). The admissible tensile force depends on the operating temperature near the drive sprockets. Within the temperature range allowed, the admissible tensile force may vary from 100% to 20% of the nominal tensile strength. For detailed information and correct calculation of effective tensile force refer to the Calculation Guide in the HabasitLINK® Engineering Guidelines.

Product liability, application considerations

If the proper selection and application of Habasit products are not recommended by an authorized Habasit sales specialist, the selection and application of Habasit products, including the related area of product safety, are the responsibility of the customer.

All indications / information are recommendations and believed to be reliable, but no representations, guarantees, or warranties of any kind are made as to their accuracy or suitability for particular applications. The data provided herein are based on laboratory work with small-scale test equipment, running at standard conditions, and do not necessarily match product performance in industrial use. New knowledge and experiences can lead to modifications and changes within a short time without prior notice.

BECAUSE CONDITIONS OF USE ARE OUTSIDE OF HABASIT'S AND ITS AFFILIATED COMPANIES CONTROL, WE CANNOT ASSUME ANY LIABILITY CONCERNING THE SUITABILITY AND PROCESS ABILITY OF THE PRODUCTS MENTIONED HEREIN. THIS ALSO APPLIES TO PROCESS RESULTS / OUTPUT / MANUFACTURING GOODS AS WELL AS TO POSSIBLE DEFECTS, DAMAGES, CONSEQUENTIAL DAMAGES, AND FURTHER-REACHING CONSEQUENCES.